

QUALITY

EXPERIENCE

PASSION



# AGRICULTURAL SHELTERS

## TYPE MULTI\_10X12



*multi* 12/10



- The MULTI\_10X12 storage shelter is mainly dedicated for storing agricultural equipment, agricultural products and building materials.
- Shelters are available in two versions of usable height: MULTI\_10X12/3,5 – 3,5m, MULTI\_10X12/4,5 – 4,5m.
- The shelter has a modular structure, that is why it can be adapted to the customer's needs and easily expanded if necessary.
- Structure of the shelter is hot dip galvanized.
- The roof of the shelter is covered with 0,7mm thick galvanized trapezoidal sheets of steel grade T50. Screens and flashings are made of 0,7mm thick varnished sheets of steel in silver colour. The fasteners are made of 2,5mm thick and 1,5mm thick galvanized sheets of steel.
- The shelter can be encased with the walls. The walls of the shelter are made of trapezoidal sheet of steel grade T35. The walls can be fitted with transom windows and a gate.
- There is a possibility of a different combination of shelters on individual customer request if it is possible in terms of design solutions and if it is possible in accordance with the technology of manufacturing.

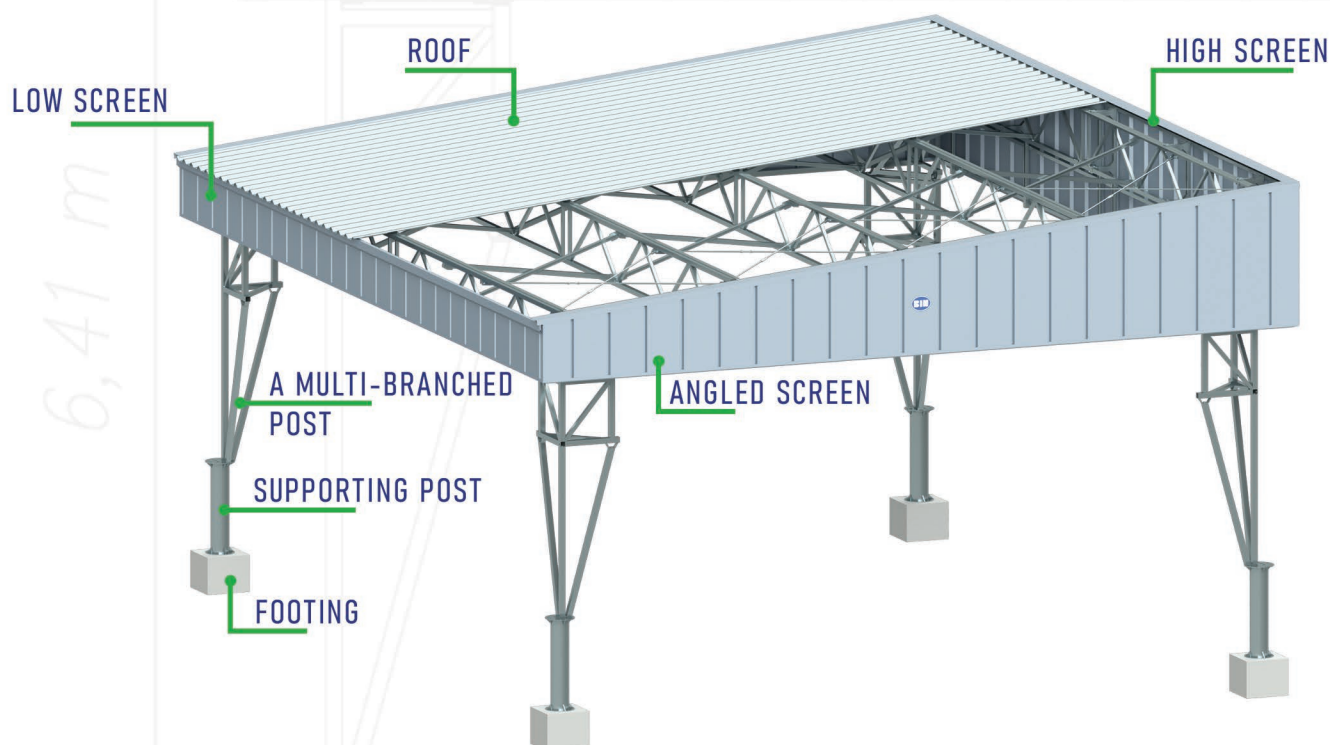

## TECHNICAL PARAMETERS OF THE SHELTER MULTI\_10X12

MULTI\_10X12/4,5

MULTI\_10X12/3,5

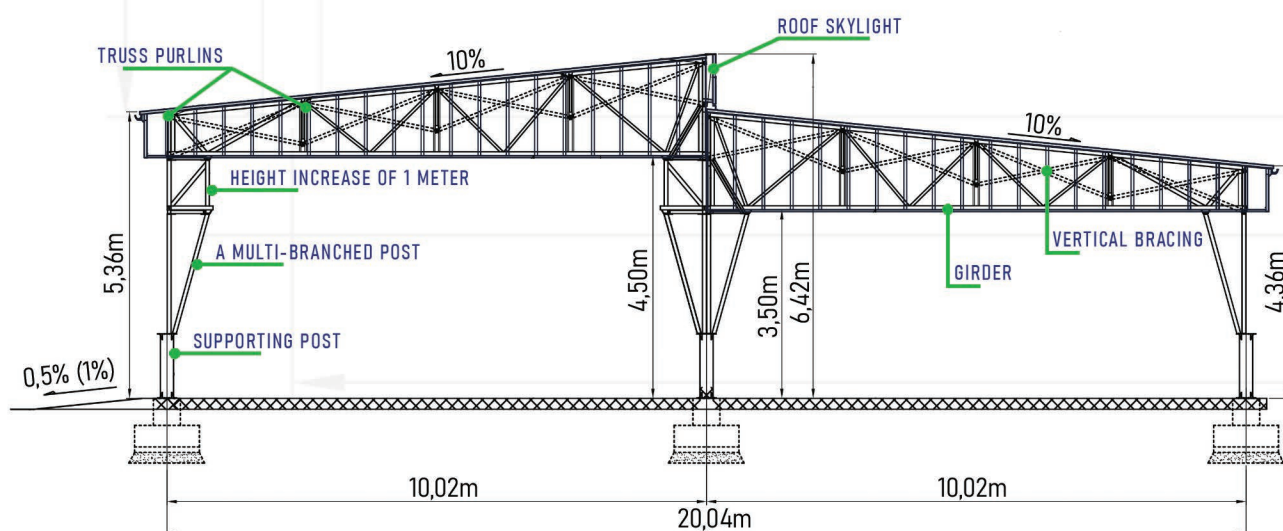



MULTI\_10X12/3,5

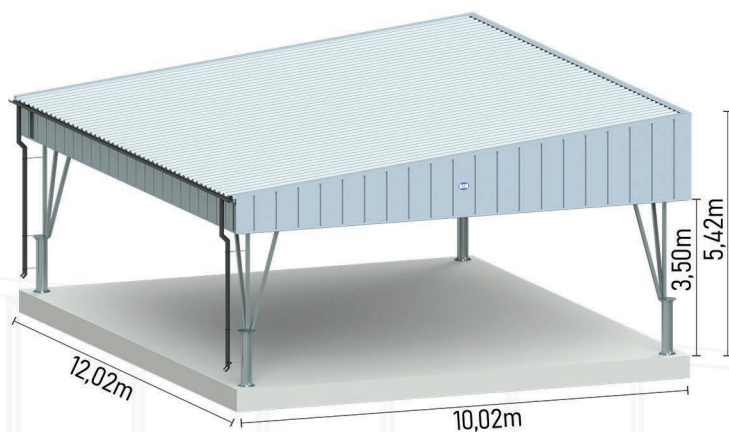

MULTI\_10X12/4,5

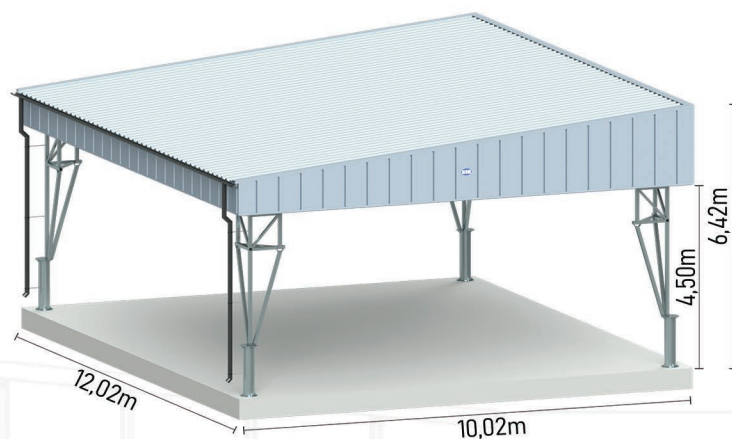

## OPTIONAL EQUIPMENT OF THE AGRICULTURAL SHELTERS

### WALLS

The structure of the shelter allows encasing it with the walls. The walls are made of trapezoidal sheets of steel grade T35. The transom windows and the gate can be installed in the walls.

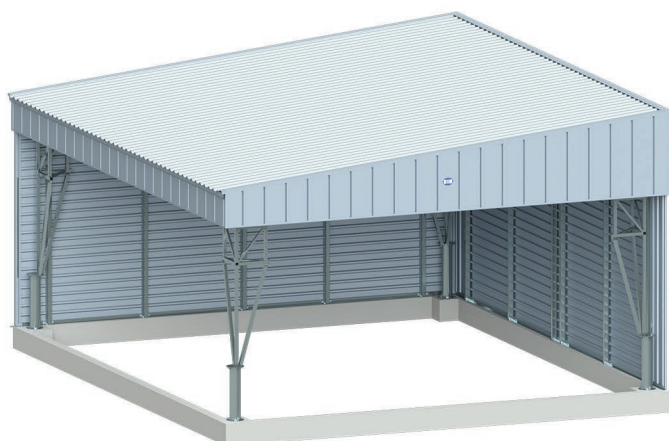

### GATES

Gates are selected due to arrangements with the customer. Most often are used a folding doors 4,5 metres wide and 3,3 metres high for the lower shelter and a folding doors 4,3 metres high for the higher shelter.

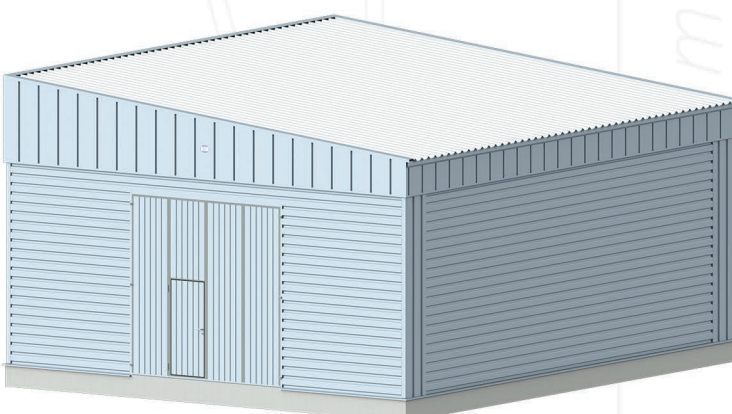

### TRANSM WINDOWS

Standard locations of the transom windows are in the walls 12 metres long and in the skylight. It is allowed, also, to use them in the walls 10 metres long.

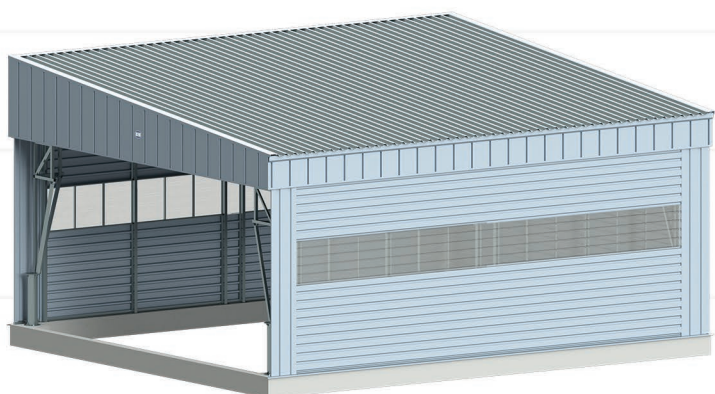

### GUTTERS

Gutters are placed near the low screen. Downpipes are located at the posts every 12m.

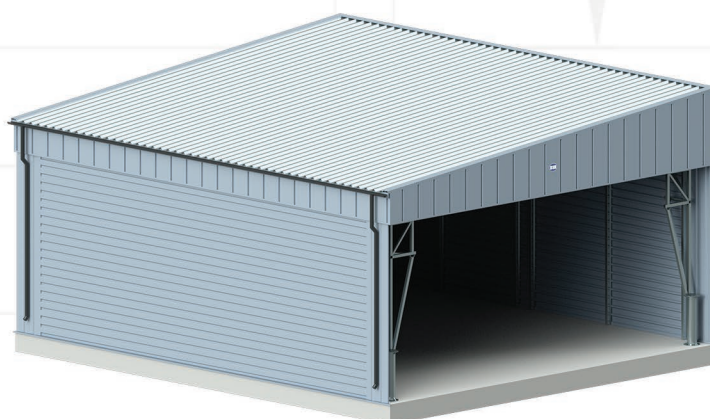



# COMBINATIONS OF SHELTERS

*multi*  $\frac{12}{10}$



## OPTION I BASIC SHELTER MULTI\_10X12/3,5



USABLE AREA - 120m<sup>2</sup>  
USABLE HEIGHT - 3,5m  
BUILDING AREA \* - 126m<sup>2</sup>

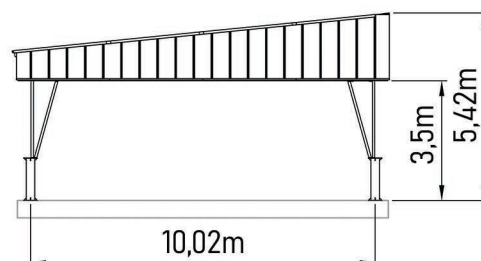

## OPTION II BASIC SHELTER MULTI\_10X12/4,5



USABLE AREA - 120m<sup>2</sup>  
USABLE HEIGHT - 4,5m  
BUILDING AREA \* - 126m<sup>2</sup>

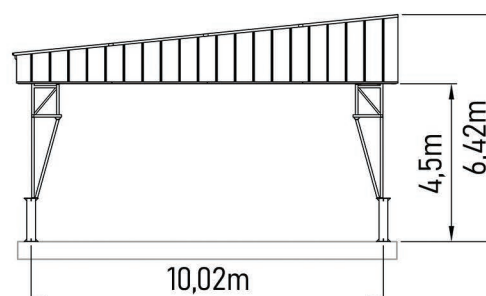

## OPTION III SET OF 2 SHELTERS MULTI\_10X12/3,5

USABLE AREA - 240m<sup>2</sup>  
USABLE HEIGHT - 3,5m  
BUILDING AREA \* - 256m<sup>2</sup>

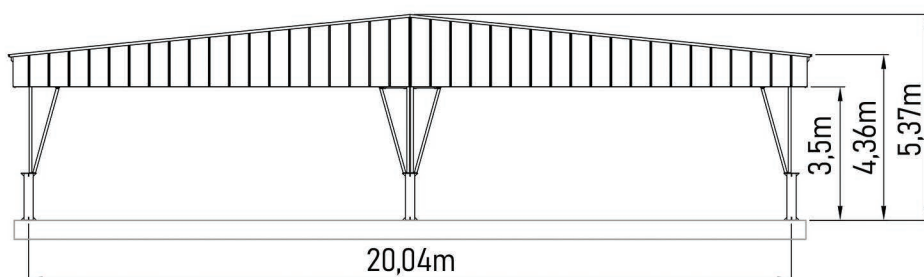
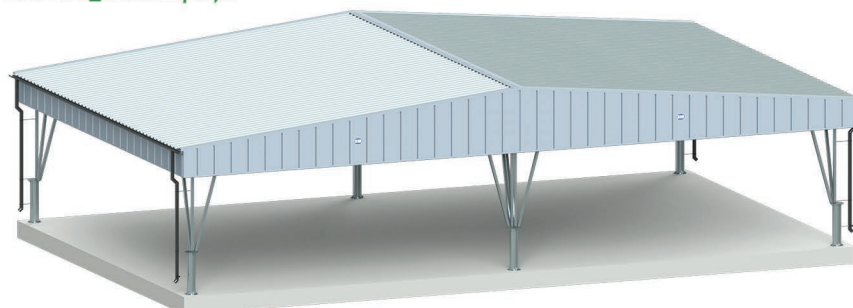

\* Building area of a shelter without walls. Please note that the building area of a shelter with the walls will be larger.





## OPTION IV

### SET OF 2 SHELTERS

MULTI\_10X12/4,5

USABLE AREA - 240m<sup>2</sup>

USABLE HEIGHT - 4,5m

BUILDING AREA \* - 256m<sup>2</sup>

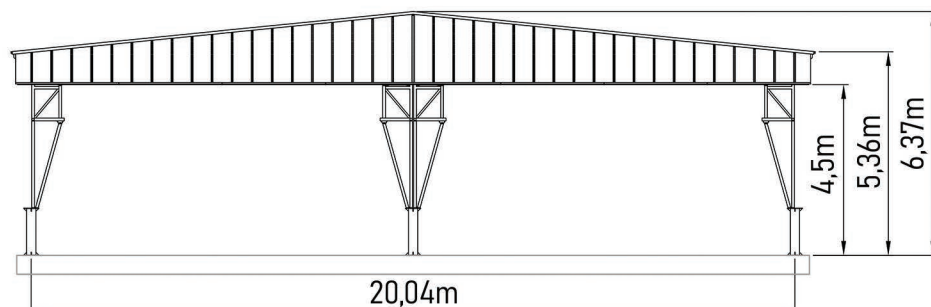
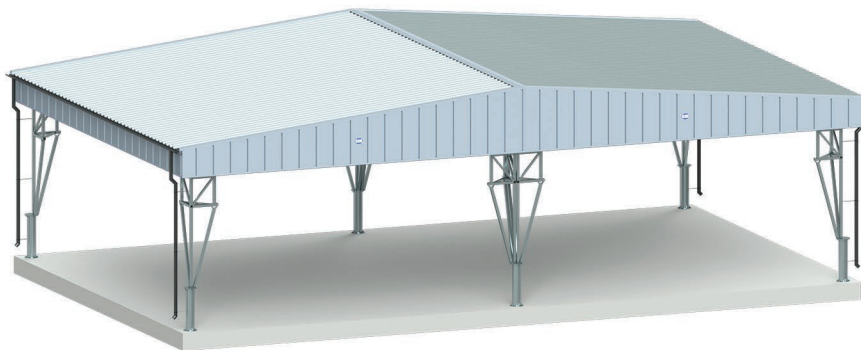

## OPTION V

SHELTER MULTI\_10X12/4,5

+ SHELTER MULTI\_10X12/3,5

USABLE AREA - 240m<sup>2</sup>

USABLE HEIGHT -

- 3,5m (120m<sup>2</sup>) and 4,5m (120m<sup>2</sup>)

BUILDING AREA \* - 256m<sup>2</sup>

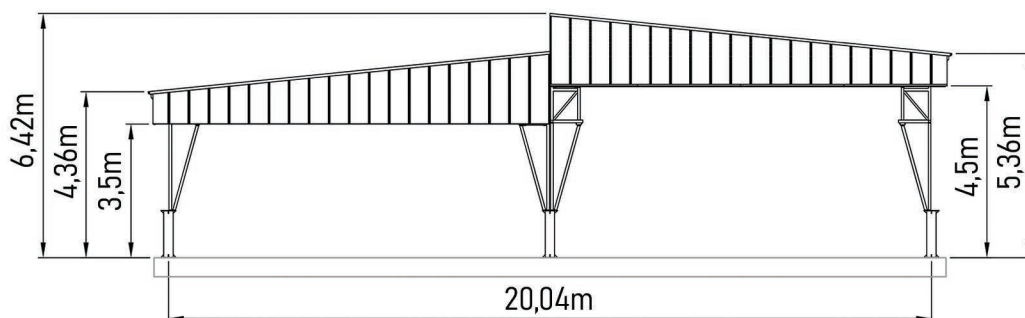
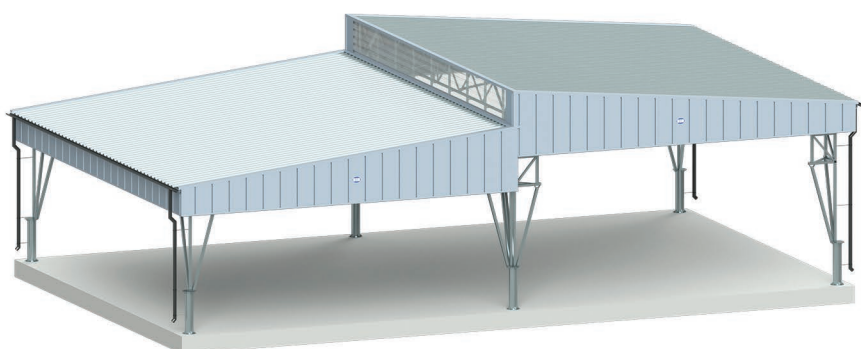

## OPTION VI

SHELTER MULTI\_10X12/3,5

+ SHELTER MULTI\_10X12/4,5

USABLE AREA - 240m<sup>2</sup>

USABLE HEIGHT -

- 3,5m (120m<sup>2</sup>) and 4,5m (120m<sup>2</sup>)

BUILDING AREA \* - 256m<sup>2</sup>

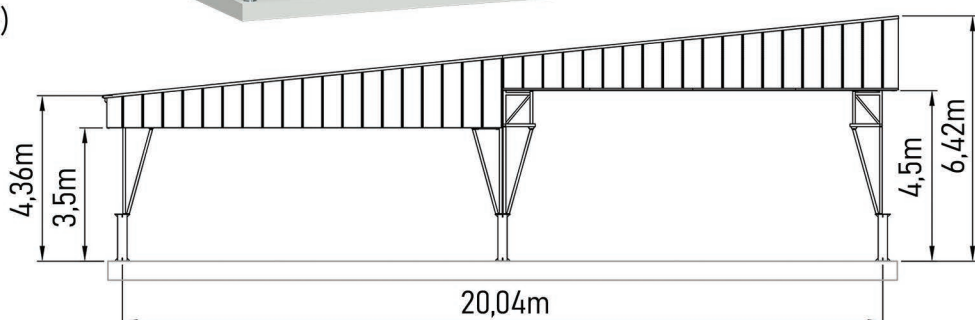
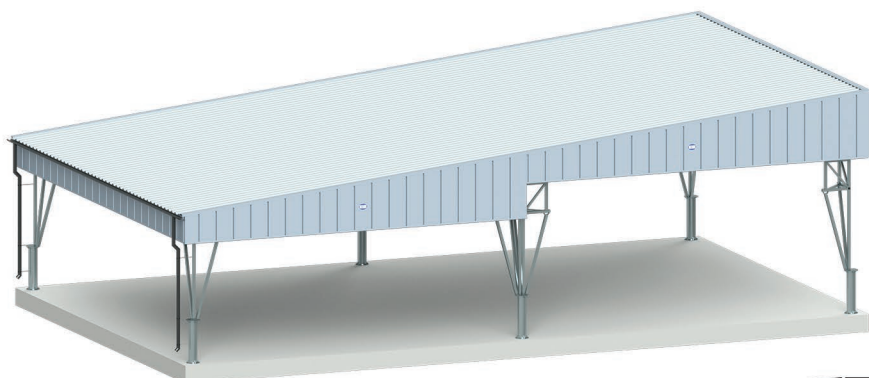

\* Building area of a shelter without walls. Please note that the building area of a shelter with the walls will be larger.



## OPTION VII SET OF 2 SHELTERS MULTI\_10X12/3,5 + MULTI\_10X12/4,5

USABLE AREA - 360m<sup>2</sup>

USABLE HEIGHT - 3,5m (240m<sup>2</sup>) and 4,5m (120m<sup>2</sup>)

BUILDING AREA \* - 381m<sup>2</sup>

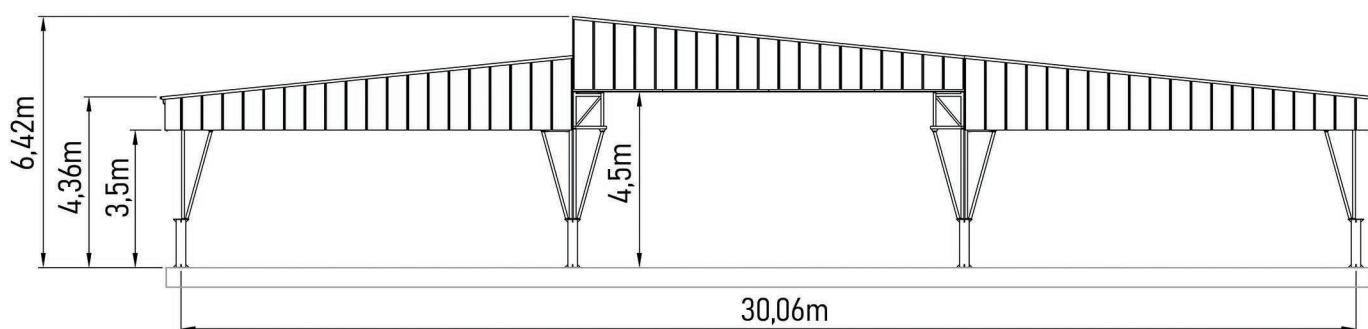
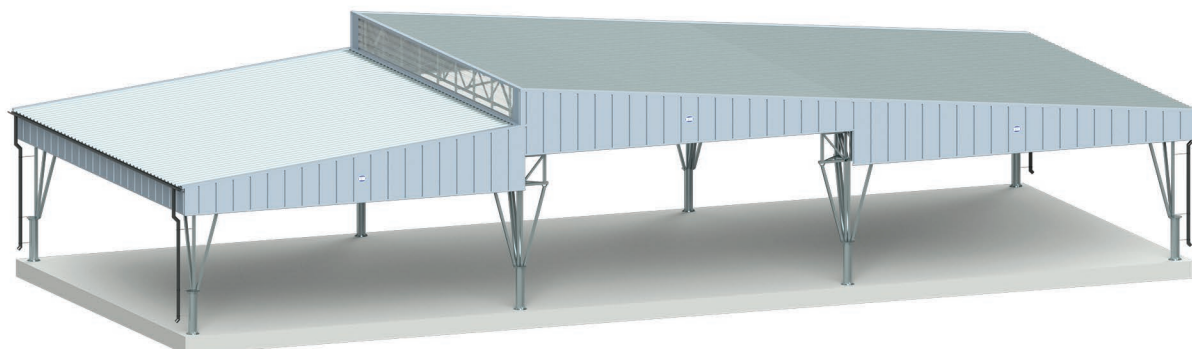

## OPTION VIII SET OF 2 SHELTERS MULTI\_10X12/3,5 + 2 SHELTERS MULTI\_10X12/4,5

USABLE AREA - 480m<sup>2</sup>

USABLE HEIGHT - 3,5m (240m<sup>2</sup>) and 4,5m (240m<sup>2</sup>)

BUILDING AREA \* - 506m<sup>2</sup>

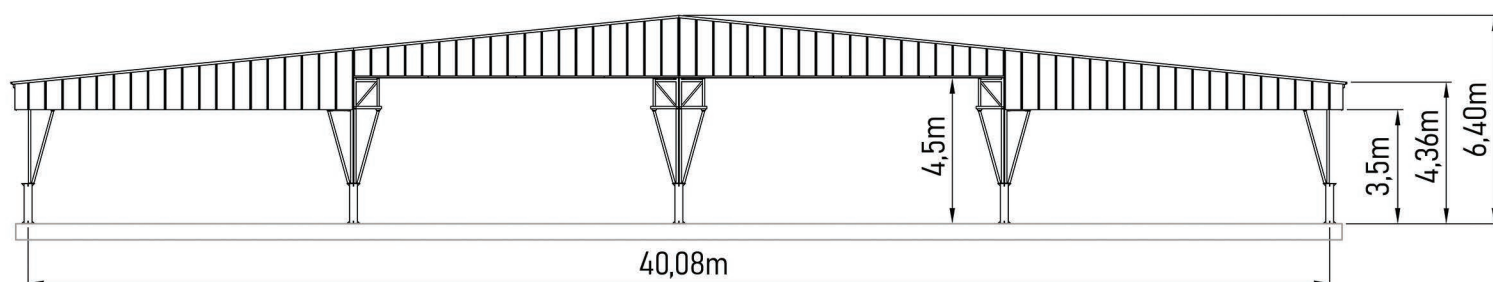
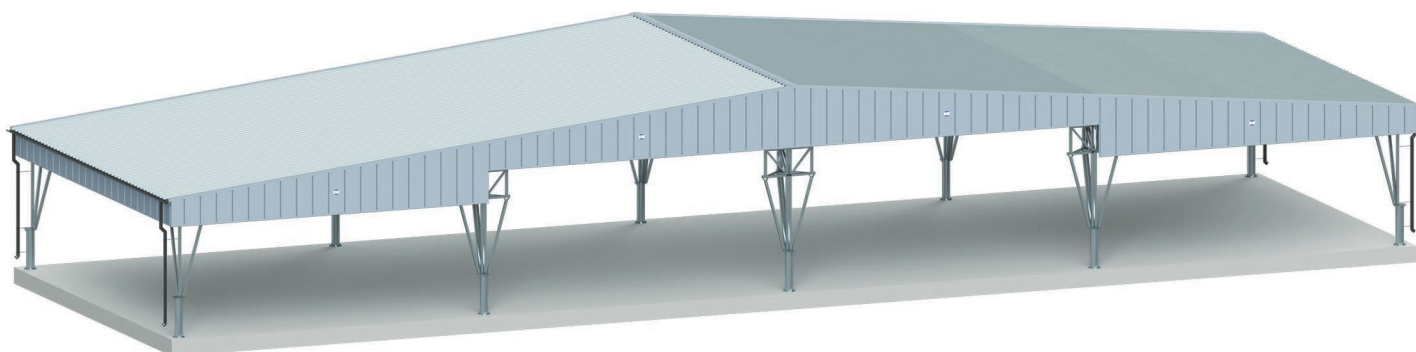

\* Building area of a shelter without walls. Please note that the building area of a shelter with the walls will be larger.



## OPTION IX SET OF 2 SHELTERS MULTI\_10X12/4,5

USABLE AREA - 240m<sup>2</sup>  
USABLE HEIGHT - 4,5m  
BUILDING AREA \* - 257m<sup>2</sup>

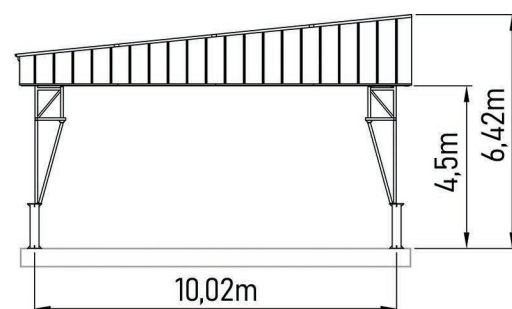
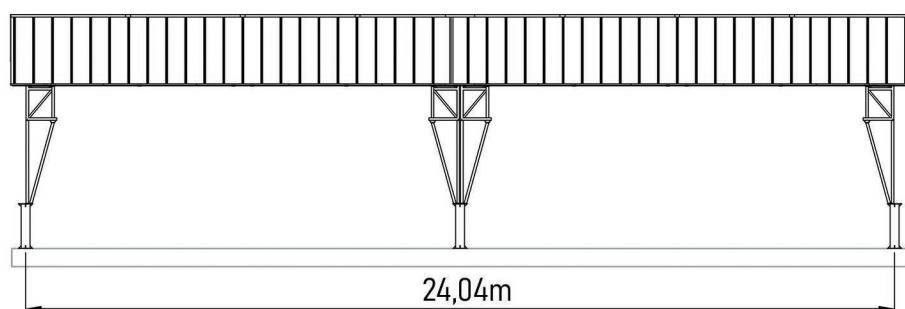
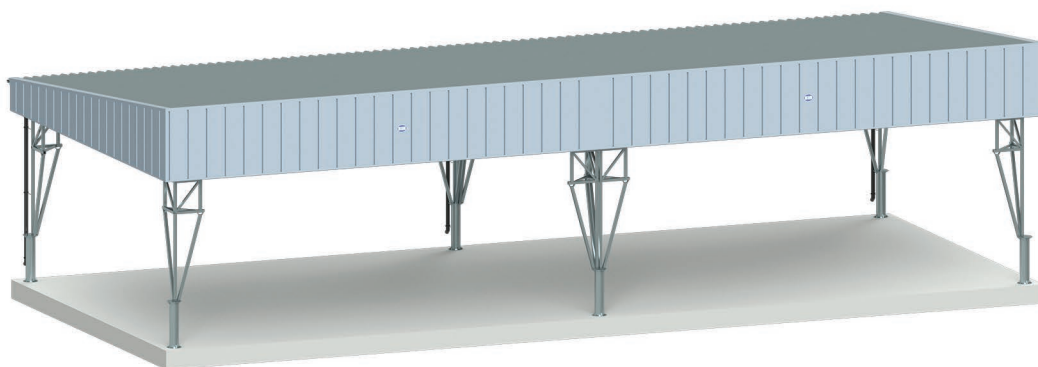

## OPTION X SET OF 2 SHELTERS MULTI\_10X12/3,5

USABLE AREA - 240m<sup>2</sup>  
USABLE HEIGHT - 3,5m  
BUILDING AREA \* - 257m<sup>2</sup>

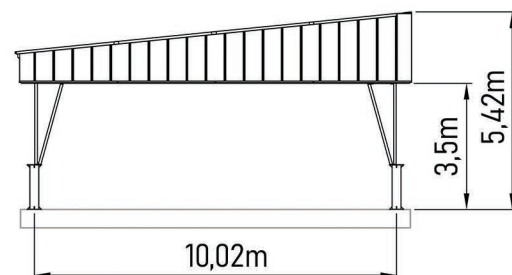
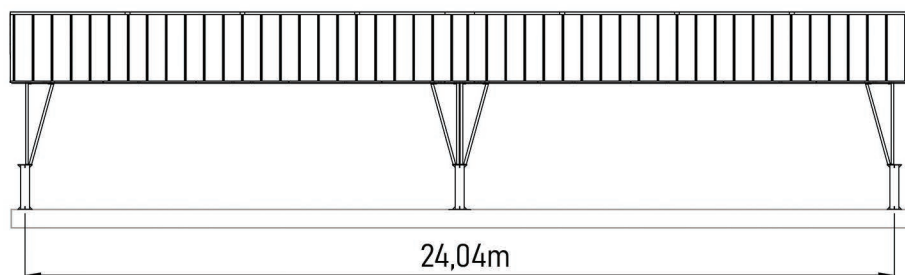
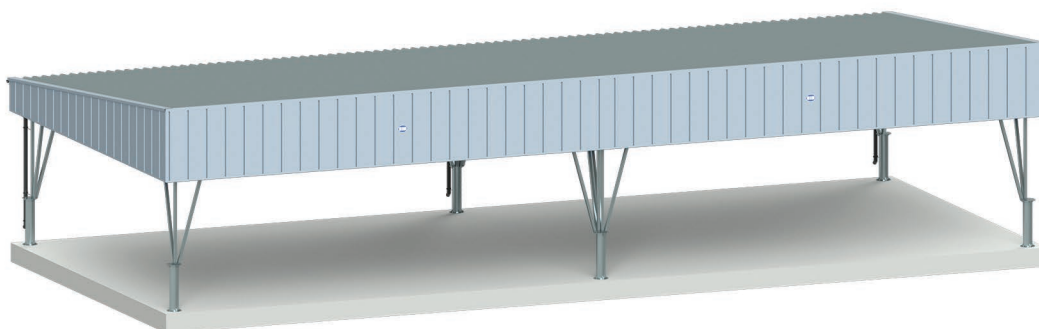

\* Building area of a shelter without walls. Please note that the building area of a shelter with the walls will be larger.



PLEASE FIND OUR FULL OFFER:

FLAT BOTTOM SILOS  
FOR GRAIN STORAGE

HOPPER SILOS FOR GRAIN STORAGE

DEVICES FOR GRAIN TRANSPORTATION

FEED SILOS AND EQUIPMENT  
FOR ON-FARM FEED MILLS

## AGRICULTURAL SHELTER TYPE MULTI\_10X12



SHELTER MULTI\_10X12/3,5 + MULTI\_10X12/4,5  
OPTION NUMBER V



SET OF 3 SHELTERS MULTI\_10X12/4,5



SET OF 4 SHELTERS MULTI\_10X12/4,5  
2 TIMES OPTION NUMBER IV



SET OF 4 SHELTERS MULTI\_10X12/4,5  
WITH WALL ENCASEMENT, THE TRANSM WINDOWS,  
AND THE GATES



SET OF 2 SHELTERS MULTI\_10X12/4,5  
WITH WALL ENCASEMENT



SHELTER MULTI\_10X12/4,5  
OPTION NUMBER II  
WITH GRAIN DRYER



SET OF 2 SHELTERS MULTI\_10X12/4,5  
OPTION NUMBER IX



**BIN Sp. z o.o.**

ul. Narutowicza 12  
87-700 Aleksandrów Kujawski  
POLAND

+48 54 282 88 05

@ export@bin.agro.pl

www.bin.agro.pl